



9

Netter Stainless Steel Electric External Vibrators Series NES



- Circular vibration
- Especially resistant to aggressive environmental conditions
- Centrifugal force from 296 N to 42.446 N
- High operational safety
- Tropical insulation by vacuum impregnation
- Protection IP 66
- Nominal frequency from 750 min⁻¹ to 3.600 min⁻¹
- Stainless steel housing
- Ex II 2 D (ATEX) versions available





NetterVibration



Netter Stainless Steel Electric External Vibrators Series NES

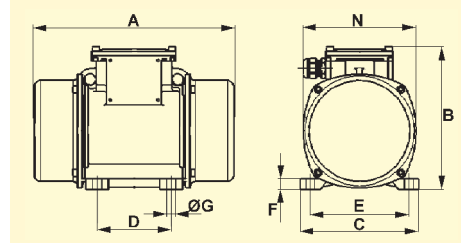

| [min ⁻¹] | Type | Working Moment [cmkg] | | Centrifugal Force [N] | | Power [kW] | | Current [A] | | Weight [kg] | | Dimensions [mm] | | | | | | |
|----------------------|------------|-----------------------|--------|-----------------------|--------|------------|-------|-------------|-------------|-------------|--------|-----------------|-----|-----|-------|-----|------|------|
| | | 50 Hz | 60 Hz | 50 Hz | 60 Hz | 50 Hz | 60 Hz | 50 Hz 400 V | 60 Hz 480 V | 50 Hz | 60 Hz | A 50/60 Hz | B | C | D | E | F | G |
| 3000 3600 | NES 50120 | 2,40 | 2,40 | 1.185 | 1.706 | 0,180 | 0,180 | 0,35 | 0,30 | 7,80 | 7,80 | 209 | 151 | 125 | 62-74 | 106 | 10 | 9 |
| | NES 50210 | 4,20 | 3,00 | 2.073 | 2.133 | 0,180 | 0,180 | 0,35 | 0,30 | 8,20 | 8,00 | 225 | 151 | 125 | 62-74 | 106 | 10 | 9 |
| | NES 50300 | 6,02 | 4,08 | 2.972 | 2.900 | 0,260 | 0,270 | 0,60 | 0,50 | 12,50 | 12,00 | 255 | 176 | 152 | 90 | 125 | 12 | 13 |
| | NES 50500 | 9,97 | 6,48 | 4.921 | 4.606 | 0,450 | 0,500 | 0,80 | 0,75 | 18,50 | 17,50 | 284 | 200 | 167 | 105 | 140 | 15 | 13 |
| | NES 50790 | 15,59 | 10,40 | 7.695 | 7.392 | 0,650 | 0,685 | 1,10 | 1,00 | 25,00 | 24,00 | 308 | 205 | 205 | 120 | 170 | 17 | 17 |
| | NES 501090 | 22,00 | 14,60 | 10.858 | 10.377 | 1,000 | 1,200 | 1,75 | 1,75 | 30,00 | 29,00 | 354 | 232 | 205 | 120 | 170 | 20 | 17 |
| | NES 501510 | 30,60 | 20,40 | 15.103 | 14.499 | 1,400 | 1,450 | 2,30 | 2,00 | 39,60 | 38,00 | 438 | 245 | 230 | 140 | 190 | 25 | 17 |
| | NES 502020 | 41,00 | 25,60 | 20.236 | 18.195 | 2,200 | 2,200 | 3,50 | 3,00 | 48,70 | 46,30 | 438 | 245 | 230 | 140 | 190 | 25 | 17 |
| 1500 1800 | NES 2530 | 2,40 | 2,40 | 296 | 426 | 0,085 | 0,095 | 0,21 | 0,20 | 7,80 | 7,80 | 209 | 151 | 125 | 62-74 | 106 | 10 | 9 |
| | NES 2580 | 6,20 | 4,20 | 766 | 747 | 0,085 | 0,095 | 0,21 | 0,20 | 9,00 | 8,70 | 225 | 151 | 125 | 62-74 | 106 | 10 | 9 |
| | NES 25100 | 7,78 | 6,20 | 960 | 1.102 | 0,085 | 0,095 | 0,21 | 0,20 | 9,40 | 9,00 | 241/225 | 151 | 125 | 62-74 | 106 | 10 | 9 |
| | NES 25210 | 16,84 | 11,76 | 2.078 | 2.090 | 0,170 | 0,170 | 0,41 | 0,40 | 15,80 | 15,00 | 295 | 176 | 152 | 90 | 125 | 12 | 13 |
| | NES 25410 | 32,64 | 22,66 | 4.028 | 4.027 | 0,300 | 0,350 | 0,60 | 0,60 | 22,50 | 21,70 | 340 | 200 | 167 | 105 | 140 | 15 | 13 |
| | NES 25550 | 43,80 | 32,64 | 5.405 | 5.800 | 0,300 | 0,350 | 0,60 | 0,60 | 23,90 | 22,50 | 380 | 200 | 167 | 105 | 140 | 15 | 13 |
| | NES 25720 | 57,18 | 41,89 | 7.056 | 7.444 | 0,525 | 0,665 | 0,92 | 0,98 | 32,00 | 30,70 | 378 | 211 | 205 | 120 | 170 | 17 | 17 |
| | NES 251030 | 83,00 | 54,20 | 10.241 | 9.630 | 0,550 | 0,680 | 0,95 | 0,95 | 42,00 | 37,50 | 434 | 232 | 205 | 120 | 170 | 20 | 17 |
| | NES 251390 | 112,20 | 80,00 | 13.844 | 14.215 | 0,900 | 1,050 | 1,45 | 1,50 | 53,00 | 50,00 | 442 | 245 | 230 | 140 | 190 | 25 | 17 |
| | NES 251760 | 143,00 | 97,00 | 17.645 | 17.235 | 1,100 | 1,200 | 2,00 | 1,90 | 58,50 | 54,50 | 490 | 245 | 230 | 140 | 190 | 25 | 17 |
| | NES 252020 | 163,40 | 112,20 | 20.162 | 19.936 | 1,350 | 1,450 | 2,50 | 2,30 | 70,00 | 68,00 | 560 | 245 | 230 | 140 | 190 | 25 | 17 |
| | NES 252380 | 192,40 | 134,80 | 23.740 | 23.951 | 1,600 | 1,700 | 3,20 | 3,00 | 82,00 | 76,00 | 525 | 285 | 275 | 155 | 225 | 30 | 22 |
| | NES 253050 | 247,00 | 171,60 | 30.477 | 30.490 | 1,900 | 2,000 | 3,80 | 3,50 | 92,00 | 89,00 | 601 | 285 | 275 | 155 | 255 | 30 | 22 |
| | NES 253770 | 305,20 | 206,80 | 37.659 | 36.745 | 2,200 | 2,500 | 3,90 | 3,90 | 115,00 | 110,00 | 589 | 323 | 310 | 155 | 255 | 35 | 23,5 |
| NES 244250 | 344,00 | 234,60 | 42.446 | 41.684 | 2,500 | 2,800 | 4,80 | 4,65 | 122,00 | 117,00 | 589 | 323 | 310 | 155 | 255 | 35 | 23,5 | |
| 1000 1200 | NES 1630 | 6,02 | 6,02 | 331 | 476 | 0,120 | 0,135 | 0,30 | 0,30 | 12,50 | 12,50 | 255 | 176 | 152 | 90 | 125 | 12 | 13 |
| | NES 16100 | 16,84 | 16,84 | 924 | 1.330 | 0,120 | 0,135 | 0,30 | 0,30 | 15,80 | 15,80 | 295 | 176 | 152 | 90 | 125 | 12 | 13 |
| | NES 16190 | 32,64 | 32,64 | 1.790 | 2.578 | 0,185 | 0,205 | 0,50 | 0,50 | 22,50 | 22,50 | 340 | 200 | 167 | 105 | 140 | 15 | 13 |
| | NES 16320 | 57,18 | 41,89 | 3.136 | 3.309 | 0,350 | 0,380 | 0,72 | 0,68 | 32,00 | 30,70 | 378 | 211 | 205 | 120 | 170 | 17 | 17 |
| | NES 16500 | 91,40 | 91,40 | 5.012 | 7.218 | 0,350 | 0,380 | 0,75 | 0,68 | 43,50 | 43,50 | 434 | 232 | 205 | 120 | 170 | 20 | 17 |
| | NES 16800 | 144,60 | 112,20 | 7.930 | 8.860 | 0,680 | 0,760 | 1,40 | 1,35 | 54,00 | 52,60 | 490/442 | 245 | 230 | 140 | 190 | 25 | 17 |
| | NES 161110 | 202,40 | 143,00 | 11.100 | 11.293 | 0,750 | 0,750 | 1,65 | 1,50 | 67,00 | 59,50 | 560/490 | 245 | 230 | 140 | 190 | 25 | 17 |
| | NES 161400 | 254,80 | 180,80 | 13.973 | 14.278 | 0,950 | 1,000 | 2,10 | 2,00 | 78,00 | 71,00 | 560 | 245 | 230 | 140 | 190 | 25 | 17 |
| | NES 161610 | 292,80 | 192,40 | 16.057 | 15.194 | 1,100 | 1,300 | 2,20 | 2,20 | 94,00 | 83,00 | 601/525 | 285 | 275 | 155 | 225 | 30 | 22 |
| | NES 162120 | 385,40 | 263,60 | 21.135 | 20.816 | 1,500 | 1,700 | 3,00 | 2,90 | 105,00 | 93,00 | 601 | 285 | 275 | 155 | 225 | 30 | 22 |
| 750 900 | NES 162550 | 465,20 | 341,20 | 25.512 | 26.944 | 1,960 | 2,100 | 4,10 | 3,75 | 130,00 | 116,00 | 657/589 | 323 | 310 | 155 | 255 | 35 | 23,5 |
| | NES 162950 | 538,00 | 388,00 | 29.504 | 30.640 | 2,200 | 2,400 | 4,50 | 4,30 | 145,00 | 130,00 | 705 | 323 | 310 | 155 | 255 | 35 | 23,5 |
| | NES 12100 | 32,64 | 32,64 | 1.007 | 1.450 | 0,230 | 0,250 | 0,85 | 0,76 | 22,50 | 22,50 | 340 | 200 | 167 | 105 | 140 | 15 | 13 |
| | NES 12180 | 56,80 | 56,80 | 1.752 | 2.523 | 0,350 | 0,380 | 1,10 | 1,05 | 32,00 | 32,00 | 378 | 211 | 205 | 120 | 170 | 17 | 17 |

Applications

The stainless steel electric vibrators of the NES series are used mainly in the chemical, pharmaceutical and food industries. They serve as drives for conveyor troughs, sieves and discharge devices.

The stainless steel surfaces of the vibrators are especially resistant to chemically corrosive environmental conditions and can be thoroughly cleaned manually and by machine with powerful cleaning agents.

Construction and Working Principle

Stainless steel electric external vibrators are three-phase current asynchronous motors with adjustable unbalances at both ends of the shaft. These unbalances generate an undirected sinusoidal vibration with the frequency of the corresponding rotation speed.

The extremely load-resistant roller bearings guarantee a long working life. All NES are suitable for operation with Netter frequency and voltage converters.

NetterVibration has a worldwide network of experienced application engineers and field representatives. We would be pleased to offer advice on site and to help optimise your applications using vibration technology.

NetterVibration offers the accessories required for the mounting, installation, control and monitoring of vibrators and impactors.

Netter provides solutions. Consult our experienced application technicians.

Netter GmbH

Germany
Fritz-Ullmann-Str. 9
55252 Mainz-Kastel
Tel. +49 6134 2901-0

Poland
Al. W. Korfanteo 195/17
40-153 Katowice
Tel. +48 32 2050947

Switzerland
Erlenweg 4
4310 Rheinfelden
Tel. +41 61 8316200

Spain
Errota Kalea 8
20150 Villabona-Guipúzcoa
Tel. +34 943 694 994

www.NetterVibration.com
info@NetterVibration.com